

Adams



Grease Fittings & Accessories

Barrettes de Graissage et Accessoires

Schottverschraubungen & Zubehör

Grease Fittings and Accessories

When it is difficult to reach a grease lubrication point, the equipment shown in this section enables it to be reached from outside. When used with the tubes and fittings shown, lubrication by grease gun can be carried out while the machine is operating.

Barrettes de Graissage et Accessoires

Lorsque le point de lubrification est difficile d'accès, les matériels de cette section permettent de le ramener à l'extérieur de la zone. Utilisés avec les tuyauteries et les raccords nécessaires, la lubrification peut être effectuée au pistolet à graisse, même pendant le fonctionnement de la machine.

Schottverschraubungen & Zubehör

Wenn der Schmierpunkt an einer unzugänglichen Stelle liegt, kann er mit Hilfe dieser Einrichtung herausgelegt werden. Mit einer entsprechenden Montageschiene können mehrere Schmierstellen an einem Ort zusammengeführt werden.

Rohre und Fittings als Zubehör ermöglichen die Schmierung sogar bei laufender Maschine.

BULKHEAD FITTING

Supplied complete with compression nut and sleeve.

Product Code	A Diameter	B mm	C mm	D mm	Clear Hole mm
BPA 3/1	3/16"	8	25	13	10
BPA 3/2	3/16"	14	32	13	10
BPA 4/1	1/4" OD	12	32	13	11.5
BPA 4/2	1/4" OD	20	38	13	11.5
BPA 6M/1	6mm OD	12	32	13	11.5
BPA 6M/2	6mm OD	20	38	13	11.5

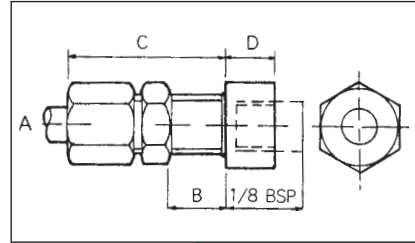

Material - BRASS Finish - NATURAL

COMPRESSION NUT (optional for use with above)

Product Code	A Diameter	B Thread	C mm	D mm	E mm
BPA 3/N	3/16" OD	1/8" BSP	10.5	8	11
BPA 4/N	1/4" OD	11mm x 1	12	8	14
BPA 6M/N	6mm OD	11mm x 1	12	8	14

Material - BRASS Finish - NATURAL

COMPRESSION SLEEVE (optional for use with above)

Product Code	A Diameter	B mm	C mm
BPA 3/S	3/16" ID	6.5	7
BPA 4/S	1/4" ID	6.5	8.5
BPA 6M/S	6mm OD	6.5	8

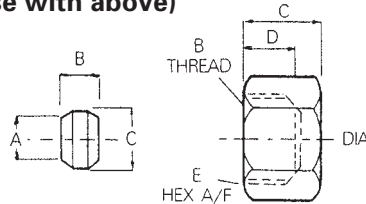

Material - BRASS Finish - NATURAL



STRAIGHT FITTINGS

Supplied with compression nut and sleeve.

Product Code	Tube OD	A Thread	B mm	C mm	D mm	E mm	Suitable Nut	Suitable Sleeve
7061	3/16"	1/8" BSP	16	9.5	11.30	11.30	1001	1021
7063/1	1/4"	1/8" BSP	18.4	9.5	13.30	15.7	1003	1023

Material - BRASS Finish - NATURAL

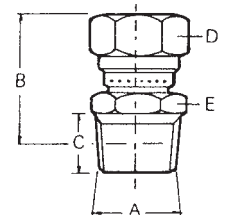

Not supplied with compression nut and sleeve. See opposite sheet for details.

Product Code	Tube OD	A Thread	B Thread	C mm	D mm	E mm	Suitable Nut	Suitable Sleeve
LV 90069	6mm	M6x1	M10x1	22	7	13	LV 90460	LV 90560
LV 90059	6mm	M8x1	M10x1	21	7	13		
LV 90067	6mm	M8x1.25	M10x1	22	6	13		
LV 90060	6mm	M10x1	M10x1	18	6	13		
LV 90068	6mm	M10x1.5	M10x1	20	6	13		
LV 90062	6mm	1/8" BSP	M10x1	18	6	13		

Material - BRASS Finish - NATURAL

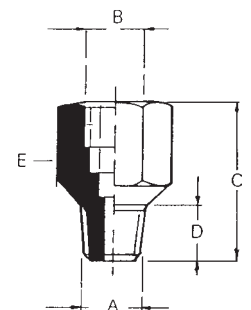

Not for use with compression nut and sleeve.

Product Code	A Thread	B Thread	C mm	D mm	E mm
50-1202-02	1/4" UNF	1/8" BSP	19	6.35	12.7
50-1202-03	5/16" UNF	1/8" BSP	19	8	12.7

Material - STEEL Finish - ZINC PLATED.

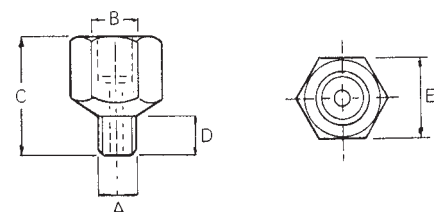

ELBOW FITTINGS - 90 DEGREES

Complete with compression nut and sleeve

Product Code	Tube OD	A Thread	B mm	C mm	D mm	E mm	Suitable Nut	Suitable Sleeve
8021	3/8"	1/8" BSP	22	18.24	9.5	11.30	1001	1021
8023/1	1/4"	1/8" BSP	23.80	18.24	9.5	15.7	1003	1023

Material - BRASS Finish - NATURAL

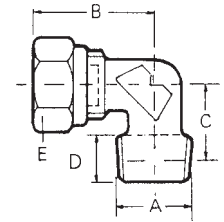

Not supplied with compression nut and sleeve. See below for details.

Product Code	Tube OD	A Thread	B Thread	C mm	D mm	E mm	Suitable Nut	Suitable Sleeve
LV 90103	6 mm	M6x1	M10x1	17	5.5	14	LV 90460	LV 90560
LV 90096	6 mm	M8x1	M10x1	17	5.5	14		
LV 90097	6 mm	M8x1.25	M10x1	17	5.5	14		
LV 90099	6 mm	M10x1	M10x1	17	5.5	14		
LV 90105	6 mm	M10x1.25	M10x1	17	5.5	14		
LV 90098	6 mm	1/8" BSP	M10x1	17	6.5	14		

Material - BRASS Finish - NATURAL

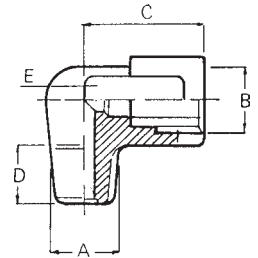

Not for use with compression nuts and sleeve

Product Code	A Thread	B Thread	C mm	D mm	E mm
51-1402-03	1/4" UNF	1/8" BSP	14.20	6.35	14.20
51-1402-02	5/16" UNF	1/8" BSP	14.20	6.35	14.20

Material - STEEL Finish - ZINC PLATED.

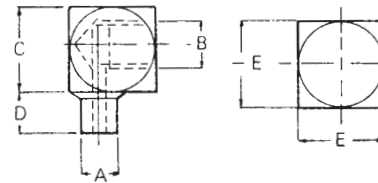

COMPRESSION TUBE NUTS AND SLEEVES.

Tube nuts

Product Code	Tube OD	A Thread	B mm	C mm
1001	3/16"	1/8" BSP	10	11.30
1003	1/4"	1/4" BSP	11	15.27
LV 90460	6mm	M10x1	13	10

Material - 1&2 BRASS Finish - NATURAL
3 - STEEL Finish - BLACK ANODISED

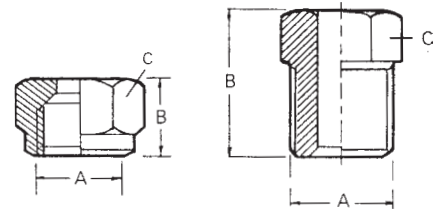

Tube sleeves

Product Code	Tube OD	A mm	B mm
1021	3/16"	5.5	6.2
1023	1/4"	6.35	8
LV 90560	6 mm	6.5	8

Material - BRASS Finish - NATURAL

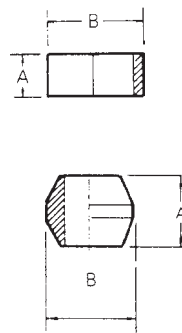

Grease nipples suitable for use with the above are shown within this catalogue



TUBING.

Nylon tube. High pressure. Colour Black

Product Code	Tube OD	Short time burst pressure
135168	$\frac{3}{16}$ "	176 Bar
135169	$\frac{1}{4}$ "	176 Bar
151027	6 mm	176 Bar

Copper tube. Standard duty. Half hard.

Product Code	Tube OD	Maximum Pressure
40 0051 03	$\frac{3}{16}$ "	192 Bar
40 0051 04	$\frac{1}{4}$ "	184 Bar
40 1021 04	6 mm	218 Bar

Double wall brazed steel tube (Bundy).

Product Code	Tube OD	Maximum Pressure
40 0067 03	$\frac{3}{16}$ "	340 Bar
40 0067 04	$\frac{1}{4}$ "	300 Bar
40 1066 04	6 mm	300 Bar



TUBING CLIPS

Single Tube.

Product Code	Tube OD	A mm	B mm
34 0218 03	$\frac{3}{16}$ "	20.3	5.1
34 0218 04	$\frac{1}{4}$ "	21.8	5.1
34 0218 04	6 mm		

Double Tube.

Product Code	Tube OD	A mm	B mm
34 0219 03	$\frac{3}{16}$ "	27.9	5.1
34 0219 04	$\frac{1}{4}$ "	32.0	5.1
34 0219 04	6 mm		

Triple Tube.

Product Code	Tube OD	A mm	B mm
34 0220 03	$\frac{3}{16}$ "	32.0	5.1
34 0220 04	$\frac{1}{4}$ "	40.0	5.1
34 0220 04	6 mm		

Material - STEEL Finish - PLATED

