



Malleabele fittingen



Pagina **483**

EE malleabel fitwerk



Pagina **491**

Lasfittingen



Pagina **489**

Pijpnippels

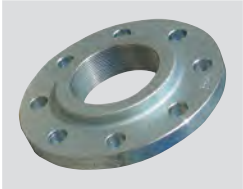

Pagina **492**

Flenzen



EE ODLEWNIA

GRUPA ZAWIERCIE

WHITEHEART MALLEABEL FITWERK

- Duurzaam geproduceerd van recycled ijzer
- Topkwaliteit voor een scherpe prijs
- Compleet en uitgebreid assortiment

TOEPASSINGEN: Persluchtssystemen, ringleidingssystemen, hydraulische systemen, sprinklerinstallaties, olie- en benzinesystemen, waterleidingen, gasleidingen, stoomleidingen, CV-systemen, gritstraalinstallaties & smeersystemen

TECHNISCHE SPECIFICATIES MATERIAAL: Whiteheart malleabel EN-GJMW-400-5 smeedbaar gietijzer, volgens EN 1562, equivalent tot W 40-05, volgens ISO 5922

VERVAARDIGING: Volgens EN 10242 en ISO 49

SCHROEFDRAAD: BSPT volgens ISO 7/1 en BSP volgens ISO 228/1

OPPERVLAKTEBEHANDELING: Zwart of gegalvaniseerd volgens EN 10242

WERKDruk: 20°C tot 120°C : 2.5 MPa (25 bar)
300°C : 2.0 MPa (20 bar)

LEKTEST: Volgens EN 10242 is elke EE fitting is onderworpen aan een lektest bij een werkdruk van minimaal 0.5 MPa (5 bar), equivalent aan een minimale hydrostatische druk van 2.0 MPa (20 bar)

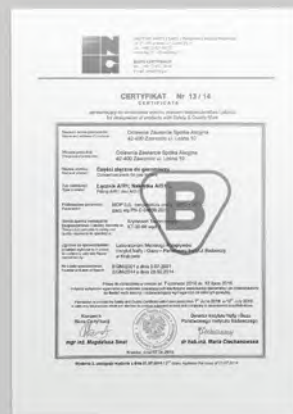
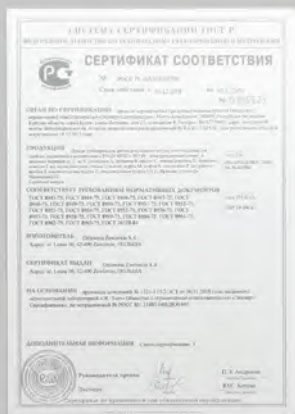



TECH DATA
20528

1-Bocht 90° male/female



Zwart - BSPT male/BSP female

6700	
46101313Z	1/4"
46101717Z	3/8"
46102121Z	1/2"
46102727Z	3/4"
46103232Z	1"
46104242Z	1.1/4"
46104848Z	1.1/2"
46106060Z	2"
46107676Z	2.1/2"
46108989Z	3"

Verzinkt - BSPT male/BSP female

6700	
46101313	1/4"
46101717	3/8"
46102121	1/2"
46102727	3/4"
46103232	1"
46104242	1.1/4"
46104848	1.1/2"
46106060	2"
46107676	2.1/2"
46108989	3"
46100114	4"

2-Bocht 90° female



Zwart - BSP female

6700	
46092121Z	1/2"
46092727Z	3/4"
46093232Z	1"
46094242Z	1.1/4"
46094848Z	1.1/2"
46096060Z	2"

Verzinkt - BSP female

6700	
46092121	1/2"
46092727	3/4"
46093232	1"
46094242	1.1/4"
46094848	1.1/2"
46096060	2"
46097676	2.1/2"
46098989	3"
46090114	4"

3-Bocht 90° male



Verzinkt - BSPT male

6700	
45032121	1/2"
45032727	3/4"
45033232	1"

40-Bocht 45° male/female



Verzinkt - BSPT male/BSP female

6700	
48101313	1/4"
48101717	3/8"
48102121	1/2"
48102727	3/4"
48103232	1"
48104242	1.1/4"
48104848	1.1/2"
48106060	2"
48107676	2.1/2"
48108989	3"
48100114	4"

41-Bocht 45° female



Zwart - BSP female

6700	
48094242Z	1.1/4"
48094848Z	1.1/2"
48096060Z	2"

Verzinkt - BSP female

6700	
48092121	1/2"
48092727	3/4"
48093232	1"
48094242	1.1/4"
48094848	1.1/2"
48096060	2"
48097676	2.1/2"
48098989	3"



TECH DATA
20528

90-Knie 90° female

Zwart - BSP female
6700

45091313Z	1/4"
45091717Z	3/8"
45092121Z	1/2"
45092727Z	3/4"
45093232Z	1"
45094242Z	1.1/4"
45094848Z	1.1/2"
45096060Z	2"
45097676Z	2.1/2"
45098989Z	3"
45090114Z	4"

Verzinkt - BSP female
6700

45091313	1/4"
45091717	3/8"
45092121	1/2"
45092727	3/4"
45093232	1"
45094242	1.1/4"
45094848	1.1/2"
45096060	2"
45097676	2.1/2"
45098989	3"
45090114	4"

92-Knie 90° male/female

Zwart - BSPT male/BSP female
6700

45101313Z	1/4"
45101717Z	3/8"
45102121Z	1/2"
45102727Z	3/4"
45103232Z	1"
45104242Z	1.1/4"
45104848Z	1.1/2"
45106060Z	2"
45107676Z	2.1/2"
45108989Z	3"

Verzinkt - BSPT male/BSP female
6700

45101313	1/4"
45101717	3/8"
45102121	1/2"
45102727	3/4"
45103232	1"
45104242	1.1/4"
45104848	1.1/2"
45106060	2"
45107676	2.1/2"
45108989	3"
45100114	4"

96-Driedelige knie conisch dichtend female



Zwart - BSP female
6700

49092121Z	1/2"
49092727Z	3/4"
49093232Z	1"
49094242Z	1.1/4"
49094848Z	1.1/2"
49096060Z	2"

Verzinkt - BSP female
6700

49091717	3/8"
49092121	1/2"
49092727	3/4"
49093232	1"
49094242	1.1/4"
49094848	1.1/2"
49096060	2"

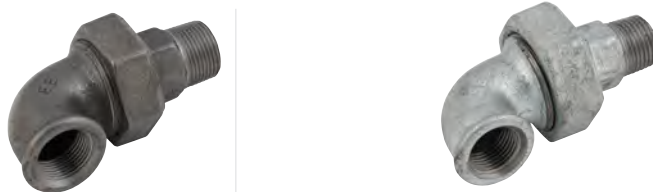
98-Driedelige knie conisch dichtend male/female

Zwart - BSPT male/BSP female
6700

49102727Z	3/4"
49103232Z	1"
49104242Z	1.1/4"
49104848Z	1.1/2"
49106060Z	2"

Verzinkt - BSPT male/BSP female
6700

49101717	3/8"
49102121	1/2"
49102727	3/4"
49103232	1"
49104242	1.1/4"
49104848	1.1/2"
49106060	2"

TECH DATA
20528

130-Tee female

Zwart - BSP female
6700

45121313Z	1/4"
45121717Z	3/8"
45122121Z	1/2"
45122727Z	3/4"
45123232Z	1"
45124242Z	1 1/4"
45124848Z	1 1/2"
45126060Z	2"
45127676Z	2 1/2"
45128989Z	3"
45120114Z	4"

Verzinkt - BSP female
6700

45121313	1/4"
45121717	3/8"
45122121	1/2"
45122727	3/4"
45123232	1"
45124242	1 1/4"
45124848	1 1/2"
45126060	2"
45127676	2 1/2"
45128989	3"
45120114	4"

130-Tee female verlopemd

Zwart - BSP female
6700

46211321Z	1/2"-1/4"-1/2"
46212721Z	1/2"-3/4"-1/2"
46271327Z	3/4"-1/4"-3/4"
46272121Z	3/4"-1/2"-1/2"
46272721Z	3/4"-3/4"-1/2"
46322132Z	1"-1/2"-1"
46423242Z	1 1/4"-1"-1 1/4"
46482748Z	1 1/2"-3/4"-1 1/2"
46483248Z	1 1/2"-1"-1 1/2"
46484248Z	1 1/2"-1 1/4"-1 1/2"
46602160Z	2"-1/2"-2"
46602760Z	2"-3/4"-2"
46603260Z	2"-1"-2"
46604260Z	2"-1 1/4"-2"
46604860Z	2"-1 1/2"-2"

Verzinkt - BSP female
6700

46211321	1/2"-1/4"-1/2"
46212721	1/2"-3/4"-1/2"
46271327	3/4"-1/4"-3/4"
46271727	3/4"-3/8"-3/4"
46272127	3/4"-1/2"-3/4"
46321732	1"-3/8"-1"
46322132	1"-1/2"-1"
46322732	1"-3/4"-1"
46323221	1"-1"-1/2"
46324832	1"-1 1/2"-1"
46422142	1 1/4"-1/2"-1 1/4"
46422732	1 1/4"-3/4"-1"
46422742	1 1/4"-3/4"-1 1/4"
46482148	1 1/2"-1/2"-1 1/2"
46482748	1 1/2"-3/4"-1 1/2"
46483242	1 1/2"-1"-1 1/4"
46483248	1 1/2"-1"-1 1/2"
46484248	1 1/2"-1 1/4"-1 1/2"
46486048	1 1/2"-2"-1 1/2"
46602160	2"-1/2"-2"
46602760	2"-3/4"-2"
46603260	2"-1"-2"
46604260	2"-1 1/4"-2"
46604860	2"-1 1/2"-2"
46762776	2 1/2"-3/4"-2 1/2"
46764876	2 1/2"-1 1/2"-2 1/2"
46766076	2 1/2"-2"-2 1/2"
46894889	3"-1 1/2"-3"
46896089	3"-2"-3"
46897689	3"-2 1/2"-3"

165-Tee 45° female

Verzinkt - BSP female
6700

48122121	1/2"
48122727	3/4"
48123232	1"
48124242	1 1/4"
48124848	1 1/2"

180-Kruisstuk female

Zwart - BSP female
6700

45322121Z	1/2"
45322727Z	3/4"
45323232Z	1"

Verzinkt - BSP female
6700

45321717	3/8"
45322121	1/2"
45322727	3/4"
45323232	1"
45324242	1 1/4"
45324848	1 1/2"
45326060	2"

221-Knie met zijspruitstuk female

Verzinkt - BSP female
6700

49991717	3/8"
49992121	1/2"
49992727	3/4"
49993232	1"



TECH DATA
20528

240-Verloopsok

Verzinkt - BSP female
6700

45071713	3/8"-1/4"
45072113	1/2"-1/4"
45072117	1/2"-3/8"
45072717	3/4"-3/8"
45072721	3/4"-1/2"
45073217	1"-3/8"
45073221	1"-1/2"
45073227	1"-3/4"
45074221	1 1/4"-1/2"
45074232	1 1/4"-1"
45074821	1 1/2"-1/2"
45074827	1 1/2"-3/4"
45074832	1 1/2"-1"
45074842	1 1/2"-1 1/4"
45076021	2"-1/2"
45076027	2"-3/4"
45076032	2"-1"
45076042	2"-1 1/4"
45076048	2"-1 1/2"
45077632	2 1/2"-1"
45077660	2 1/2"-2"
45078960	3"-2"
45078976	3"-2 1/2"
45711460	4"-2"
45711489	4"-3"

241-Verloopring

Zwart - BSPT male/BSP female
6700

45041713Z	3/8"-1/4"
45042113Z	1/2"-1/4"
45042117Z	1/2"-3/8"
45042713Z	3/4"-1/4"
45042717Z	3/4"-3/8"
45042721Z	3/4"-1/2"
45043217Z	1"-3/8"
45043221Z	1"-1/2"
45043227Z	1"-3/4"
45044221Z	1 1/4"-1/2"
45044227Z	1 1/4"-3/4"
45044232Z	1 1/4"-1"
45044827Z	1 1/2"-3/4"
45044832Z	1 1/2"-1"
45044842Z	1 1/2"-1 1/4"
45046021Z	2"-1/2"
45046027Z	2"-3/4"
45046032Z	2"-1"
45046042Z	2"-1 1/4"
45046048Z	2"-1 1/2"

Verzinkt - BSPT male/BSP female
6700

45041713	3/8"-1/4"
45042113	1/2"-1/4"
45042117	1/2"-3/8"
45042713	3/4"-1/4"
45042717	3/4"-3/8"
45042721	3/4"-1/2"
45043217	1"-3/8"
45043221	1"-1/2"
45043227	1"-3/4"
45044217	1 1/4"-3/8"
45044221	1 1/4"-1/2"
45044227	1 1/4"-3/4"
45044232	1 1/4"-1"
45044821	1 1/2"-1/2"
45044827	1 1/2"-3/4"
45044832	1 1/2"-1"
45044842	1 1/2"-1 1/4"
45046021	2"-1/2"
45046027	2"-3/4"
45046032	2"-1"
45046042	2"-1 1/4"
45046048	2"-1 1/2"
45047632	2 1/2"-1"
45047642	2 1/2"-1 1/4"
45047648	2 1/2"-1 1/2"
45047660	2 1/2"-2"
45048932	3"-1"
45048948	3"-1 1/2"
45048960	3"-2"
45048976	3"-2 1/2"
45411460	4"-2"
45411476	4"-2 1/2"
45411489	4"-3"

245-Verloopnippel

Zwart - BSPT male
6700

45021713Z	3/8"-1/4"
45022113Z	1/2"-1/4"
45022117Z	1/2"-3/8"
45022717Z	3/4"-3/8"
45022721Z	3/4"-1/2"
45023221Z	1"-1/2"
45023227Z	1"-3/4"
45024232Z	1 1/4"-1"
45024832Z	1 1/2"-1"
45024842Z	1 1/2"-1 1/4"
45026032Z	2"-1"
45026042Z	2"-1 1/4"
45026048Z	2"-1 1/2"

Verzinkt - BSPT male
6700

45021713	3/8"-1/4"
45022113	1/2"-1/4"
45022117	1/2"-3/8"
45022717	3/4"-3/8"
45022721	3/4"-1/2"
45023221	1"-1/2"
45023227	1"-3/4"
45024221	1 1/4"-1/2"
45024227	1 1/4"-3/4"
45024232	1 1/4"-1"
45024827	1 1/2"-3/4"
45024832	1 1/2"-1"
45024842	1 1/2"-1 1/4"
45026032	2"-1"
45026042	2"-1 1/4"
45026048	2"-1 1/2"
45027648	2 1/2"-1 1/2"
45027660	2 1/2"-2"
45028960	3"-2"
45028976	3"-2 1/2"



TECH DATA
20528

246-Soknippel verlopend



Verzinkt - BSP
female/BSPT male

6700



45081713	3/8"-1/4"
45082113	1/2"-1/4"
45082117	1/2"-3/8"
45082717	3/4"-3/8"
45082721	3/4"-1/2"
45083221	1"-1/2"
45083227	1"-3/4"
45084227	1.1/4"-3/4"
45084232	1.1/4"-1"
45084832	1.1/2"-1"
45084842	1.1/2"-1.1/4"
45086042	2"-1.1/4"
45086048	2"-1.1/2"

270-Sok



Zwart - BSP female

6700



45061313Z	1/4"
45061717Z	3/8"
45062121Z	1/2"
45062727Z	3/4"
45063232Z	1"
45064242Z	1.1/4"
45064848Z	1.1/2"
45066060Z	2"

Verzinkt - BSP female

6700



45061313	1/4"
45061717	3/8"
45062121	1/2"
45062727	3/4"
45063232	1"
45064242	1.1/4"
45064848	1.1/2"
45066060	2"
45067676	2.1/2"
45068989	3"
45060114	4"

280-Dubbele nippel



Zwart - BSPT male

6700



45001313Z	1/4"
45001717Z	3/8"
45002121Z	1/2"
45002727Z	3/4"
45003232Z	1"
45004242Z	1.1/4"
45004848Z	1.1/2"
45006060Z	2"
45007676Z	2.1/2"
45008989Z	3"

Verzinkt - BSPT male

6700



45001313	1/4"
45001717	3/8"
45002121	1/2"
45002727	3/4"
45003232	1"
45004242	1.1/4"
45004848	1.1/2"
45006060	2"
45007676	2.1/2"
45008989	3"
45000114	4"

300-Kap zeskant



Zwart - BSP female

6700



45261300Z	1/4"
45261700Z	3/8"
45262100Z	1/2"
45262700Z	3/4"
45263200Z	1"
45264200Z	1.1/4"
45264800Z	1.1/2"
45266000Z	2"
45267600Z	2.1/2"
45268900Z	3"
45261140Z	4"

290-Plug met vierkante kop



Zwart - BSPT male

6700



45181300Z	1/4"
45181700Z	3/8"
45182100Z	1/2"
45182700Z	3/4"
45183200Z	1"
45184200Z	1.1/4"
45184800Z	1.1/2"
45186000Z	2"
45187600Z	2.1/2"
45188900Z	3"
45181140Z	4"

Verzinkt - BSPT male

6700



45181300	1/4"
45181700	3/8"
45182100	1/2"
45182700	3/4"
45183200	1"
45184200	1.1/4"
45184800	1.1/2"
45186000	2"
45187600	2.1/2"
45188900	3"
45181140	4"

Verzinkt - BSP female

6700



45261300	1/4"
45261700	3/8"
45262100	1/2"
45262700	3/4"
45263200	1"
45264200	1.1/4"
45264800	1.1/2"
45266000	2"
45267600	2.1/2"
45268900	3"
45261140	4"



TECH DATA
20528

310-Sluitmoer zeskant



Verzinkt - BSP female

6700

45301700	3/8"
45302100	1/2"
45302700	3/4"
45303200	1"
45304200	1.1/4"
45304800	1.1/2"
45306000	2"

340-Driedelige koppeling conisch dichtend female



Zwart - BSP female

6700

4606171Z	3/8"
46062121Z	1/2"
46062727Z	3/4"
46063232Z	1"
46064242Z	1.1/4"
46064848Z	1.1/2"
46066060Z	2"
46067676Z	2.1/2"
46068989Z	3"

Verzinkt - BSP female

6700

46061717	3/8"
46062121	1/2"
46062727	3/4"
46063232	1"
46064242	1.1/4"
46064848	1.1/2"
46066060	2"
46067676	2.1/2"
46068989	3"
46061140	4"

341-Driedelige koppeling conisch dichtend male/female



Zwart - BSPT male/BSP female

6700



47081717Z	3/8"
47082121Z	1/2"
47082727Z	3/4"
47083232Z	1"
47084242Z	1.1/4"
47084848Z	1.1/2"
47086060Z	2"
47087676Z	2.1/2"
47088989Z	3"

Verzinkt - BSPT male/BSP female

6700

47081717	3/8"
47082121	1/2"
47082727	3/4"
47083232	1"
47084242	1.1/4"
47086060	2"
47084848	1.1/2"
47087676	2.1/2"
47088989	3"
47080114	4"

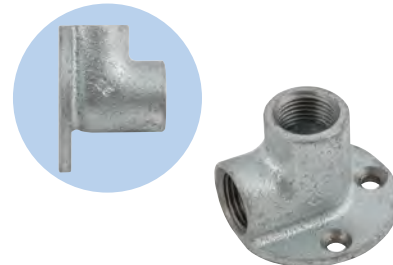
471-Muurplaat female



Verzinkt - BSP female

6700

45472121	1/2"
45472727	3/4"

529A-Soknippel



Verzinkt - BSPT male/BSP female

6700

46082121	1/2"
46082727	3/4"
46083232	1"

Voor

schroefdraaddichting- en borging



...zie pagina 586







Pijpnippels - staal



23-Pijpnippel



Zwart - BSPT male - DIN 2982

MALZ		
45313040Z	1/4"	40
45313060Z	1/4"	60
45313080Z	1/4"	80
45313100Z	1/4"	100
45313120Z	1/4"	120
45313150Z	1/4"	150
45313180Z	1/4"	180
45313200Z	1/4"	200
45313250Z	1/4"	250
45313300Z	1/4"	300
45317030Z	3/8"	30
45317040Z	3/8"	40
45317060Z	3/8"	60
45317080Z	3/8"	80
45317100Z	3/8"	100
45317120Z	3/8"	120
45317150Z	3/8"	150
45317180Z	3/8"	180
45317200Z	3/8"	200
45317250Z	3/8"	250
45317300Z	3/8"	300
45321030Z	1/2"	30
45321040Z	1/2"	40
45321060Z	1/2"	60
45321080Z	1/2"	80
45321100Z	1/2"	100
45321120Z	1/2"	120
45321150Z	1/2"	150
45321180Z	1/2"	180
45321200Z	1/2"	200
45321250Z	1/2"	250
45321300Z	1/2"	300
45327040Z	3/4"	40

MALZ		
45327060Z	3/4"	60
45327080Z	3/4"	80
45327100Z	3/4"	100
45327120Z	3/4"	120
45327150Z	3/4"	150
45327180Z	3/4"	180
45327200Z	3/4"	200
45327250Z	3/4"	250
45327300Z	3/4"	300
45332040Z	1"	40
45332060Z	1"	60
45332080Z	1"	80
45332100Z	1"	100
45332120Z	1"	120
45332150Z	1"	150
45332180Z	1"	180
45332200Z	1"	200
45332250Z	1"	250
45332300Z	1"	300
45342060Z	1,1/4"	60
45342080Z	1,1/4"	80
45342100Z	1,1/4"	100
45342120Z	1,1/4"	120
45342150Z	1,1/4"	150
45342180Z	1,1/4"	180
45342200Z	1,1/4"	200
45342250Z	1,1/4"	250
45342300Z	1,1/4"	300
45348060Z	1,1/2"	60
45348080Z	1,1/2"	80
45348100Z	1,1/2"	100
45348120Z	1,1/2"	120
45348150Z	1,1/2"	150

MALZ		
45348180Z	1,1/2"	180
45348200Z	1,1/2"	200
45348250Z	1,1/2"	250
45348300Z	1,1/2"	300
45360080Z	2"	80
45360100Z	2"	100
45360120Z	2"	120
45360150Z	2"	150
45360180Z	2"	180
45360200Z	2"	200
45360250Z	2"	250
45360300Z	2"	300
45376100Z	2,1/2"	100
45376120Z	2,1/2"	120
45376150Z	2,1/2"	150
45376180Z	2,1/2"	180
45376200Z	2,1/2"	200
45376250Z	2,1/2"	250
45376300Z	2,1/2"	300
45389100Z	3"	100
45389120Z	3"	120
45389150Z	3"	150
45389180Z	3"	180
45389200Z	3"	200
45389250Z	3"	250
45389300Z	3"	300
45314100Z	4"	100
45314120Z	4"	120
45314150Z	4"	150
45314180Z	4"	180
45314200Z	4"	200
45314250Z	4"	250
45314300Z	4"	300



Pijpnippels - staal

23-Pijpnippel



Verzinkt - BSPT male - DIN 2982



45311060	1/8"	60
45311080	1/8"	80
45313040	1/4"	40
45313060	1/4"	60
45313080	1/4"	80
45313100	1/4"	100
45313120	1/4"	120
45313150	1/4"	150
45313180	1/4"	180
45313200	1/4"	200
45313250	1/4"	250
45313300	1/4"	300
45317030	3/8"	30
45317040	3/8"	40
45317060	3/8"	60
45317080	3/8"	80
45317100	3/8"	100
45317120	3/8"	120
45317150	3/8"	150
45317180	3/8"	180
45317200	3/8"	200
45317250	3/8"	250
45317300	3/8"	300
45321030	1/2"	30
45321040	1/2"	40
45321060	1/2"	60
45321080	1/2"	80
45321100	1/2"	100
45321120	1/2"	120
45321150	1/2"	150
45321180	1/2"	180
45321200	1/2"	200
45321250	1/2"	250
45321300	1/2"	300



45327040	3/4"	40
45327060	3/4"	60
45327080	3/4"	80
45327100	3/4"	100
45327120	3/4"	120
45327150	3/4"	150
45327180	3/4"	180
45327200	3/4"	200
45327250	3/4"	250
45327300	3/4"	300
45332040	1"	40
45332060	1"	60
45332080	1"	80
45332100	1"	100
45332120	1"	120
45332150	1"	150
45332180	1"	180
45332200	1"	200
45332250	1"	250
45332300	1"	300
45342060	1,1/4"	60
45342080	1,1/4"	80
45342100	1,1/4"	100
45342120	1,1/4"	120
45342150	1,1/4"	150
45342180	1,1/4"	180
45342200	1,1/4"	200
45342250	1,1/4"	250
45342300	1,1/4"	300
45348060	1,1/2"	60
45348080	1,1/2"	80
45348100	1,1/2"	100
45348120	1,1/2"	120
45348150	1,1/2"	150



45348180	1,1/2"	180
45348200	1,1/2"	200
45348250	1,1/2"	250
45348300	1,1/2"	300
45360080	2"	80
45360100	2"	100
45360120	2"	120
45360150	2"	150
45360180	2"	180
45360200	2"	200
45360250	2"	250
45360300	2"	300
45376100	2,1/2"	100
45376120	2,1/2"	120
45376150	2,1/2"	150
45376180	2,1/2"	180
45376200	2,1/2"	200
45376250	2,1/2"	250
45376300	2,1/2"	300
45389100	3"	100
45389120	3"	120
45389150	3"	150
45389180	3"	180
45389200	3"	200
45389250	3"	250
45389300	3"	300
45314100	4"	100
45314120	4"	120
45314150	4"	150
45314180	4"	180
45314200	4"	200
45314250	4"	250
45314300	4"	300



Lasfittingen

Materiaal: Normaal wandig staal 37.0.S (naadloos)
Kwaliteitscontrole: T.U.V. Quality systems, Fabricage volgens DIN.
Oppervlaktebehandeling: Zwart

Barstdruk: 80 bar
Werkdruk: 30 bar
 (bij +20°C)

Lasbocht 90°



Zwart DIN 2605 (Staal 37.0.S)

MALZ		OD (mm)	(mm)
45192100Z	1/2"	21,3	2,0
45192700Z	3/4"	26,9	2,3
45193200Z	1"	33,7	2,6
45194200Z	1.1/4"	42,4	2,6
45194800Z	1.1/2"	48,3	2,6
45196000Z	2"	60,3	2,9
45197600Z	2.1/2"	76,1	2,9
45198600Z	3"	88,9	3,2
45198700Z	101	101,6	3,6
45198900Z	108	108,0	3,6
45191140Z	4"	114,3	3,6

Lasbocht 45°

TECH DATA
30231



Zwart DIN 2605 (Staal 37.0.S)

MALZ		OD (mm)	(mm)
46192100Z	1/2"	21,3	2,0
46192700Z	3/4"	26,9	2,3
46193200Z	1"	33,7	2,6
46194200Z	1.1/4"	42,4	2,6
46194800Z	1.1/2"	48,3	2,6
46196000Z	2"	60,3	2,9
46197600Z	2.1/2"	76,1	2,9
46198600Z	3"	88,9	3,2
46191140Z	4"	114,3	3,6

Lassok egaal

TECH DATA
30232



Female - DIN 2986 (Staal 37.0.S)

MALZ		OD (mm)	L (mm)
45161000Z	1/8"	14,7	17
45161300Z	1/4"	18,4	25
45161700Z	3/8"	21,4	26
45162100Z	1/2"	26,8	34
45162700Z	3/4"	32,0	36
45163200Z	1"	39,7	43
45164200Z	1.1/4"	48,7	48
45164800Z	1.1/2"	55,3	48
45166000Z	2"	66,2	56
45167600Z	2.1/2"	82,6	65
45168900Z	3"	95,5	71
45161140Z	4"	122,0	83

Sokken

Gesmede sok egaal



Gegalvaniseerd - BSP female

MALF	BSPF
MIWRSG-18	1/8"
MIWRSG-14	1/4"
MIWRSG-38	3/8"
MIWRSG-12	1/2"
MIWRSG-34	3/4"
MIWRSG-1	1"
MIWRSG-114	1.1/4"
MIWRSG-112	1.1/2"
MIWRSG-2	2"
MIWRSG-212	2.1/2"
MIWRSG-3	3"
MIWRSG-4	4"



Zwart - BSP female

MALF	BSPF
MIWRSB-18N	1/8"
MIWRSB-14N	1/4"
MIWRSB-38N	3/8"
MIWRSB-12N	1/2"
MIWRSB-34N	3/4"
MIWRSB-1N	1"
MIWRSB-114N	1.1/4"
MIWRSB-112N	1.1/2"
MIWRSB-2N	2"
MIWRSB-212N	2.1/2"
MIWRSB-3N	3"
MIWRSB-4N	4"



Flenzen - staal

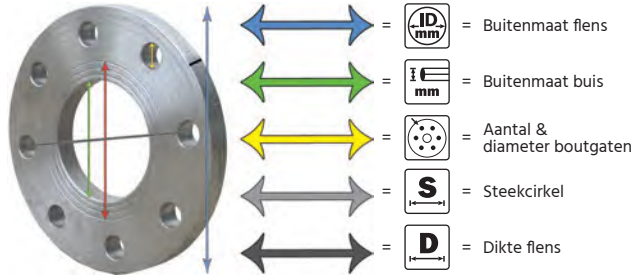

Topkwaliteit voor een breed scala aan toepassingen binnen de chemische en petrochemische industrie, offshore, etc.

Naast dit assortiment van meest toegepaste flenzen zijn een groot aantal types en maten op aanvraag leverbaar.

Draadflenzen staal C22,8, volgens DIN normering 2566

Voorlasflenzen staal C22,8 volgens DIN normering 2633 (2631/2635)

Vlakke lasflenzen staal 37,2 volgens normering EN1092-1 (voorheen DIN 2576)

Blindflenzen staal 37, volgens normering EN1092-5 (voorheen DIN 2527)

Draadflenzen staal DIN 2566



Verzinkt - DIN 2566 ST37 - 16 bar

FLEN	S	D		ID (mm)	i (mm)	
DN15-DF16B-12	65	14	1/2"	95	21,3	4 x 14mm
DN20-DF16B-34	75	16	3/4"	105	26,9	4 x 14mm
DN25-DF16B-1	85	16	1"	115	33,7	4 x 14mm
DN32-DF16B-114	100	16	1,1/4"	140	42,4	4 x 18mm
DN40-DF16B-112	110	16	1,1/2"	150	48,3	4 x 18mm
DN50-DF16B-2	125	18	2"	165	60,3	4 x 18mm
DN65-DF16B-212	145	18	2,1/2"	185	76,1	8 x 18mm
DN80-DF16B-3	160	20	3"	200	88,9	8 x 18mm
DN100-DF16B-4	180	20	4"	220	114,3	8 x 18mm



Zwart - DIN 2566 ST37 - 16 bar

FLEN	S	D		ID (mm)	i (mm)	
DN15-DF16B-12Z	65	14	1/2"	95	21,3	4 x 14mm
DN20-DF16B-34Z	75	16	3/4"	105	26,9	4 x 14mm
DN25-DF16B-1Z	85	16	1"	115	33,7	4 x 14mm
DN32-DF16B-114Z	100	16	1,1/4"	140	42,4	4 x 18mm
DN40-DF16B-112Z	110	16	1,1/2"	150	48,3	4 x 18mm
DN50-DF16B-2Z	125	18	2"	165	60,3	4 x 18mm
DN65-DF16B-212Z	145	18	2,1/2"	185	76,1	8 x 18mm
DN80-DF16B-3Z	160	20	3"	200	88,9	8 x 18mm
DN100-DF16B-4Z	180	20	4"	220	114,3	8 x 18mm

Voorlasflenzen staal DIN 2633

Voorlasflenzen in PN6 (DIN 2631), PN10 (DIN 2632) en PN40 (DIN 2635) en in andere maten zijn op aanvraag leverbaar.



Staal DIN 2633 C22,8 - 16 bar

FLEN	S	D		ID (mm)	
DN015-VLF021-16	65	14	95	21,3	4 x 14mm
DN020-VLF026-16	75	16	105	26,9	4 x 14mm
DN025-VLF033-16	85	16	115	33,7	4 x 14mm
DN032-VLF042-16	100	16	140	42,4	4 x 18mm
DN040-VLF048-16	110	16	150	48,3	4 x 18mm
DN050-VLF060-16	125	18	165	60,3	4 x 18mm
DN065-VLF076-16	145	18	185	76,1	8 x 18mm
DN080-VLF088-16	160	20	200	88,9	8 x 18mm
DN100-VLF114-16	180	20	220	114,3	8 x 18mm
DN125-VLF139-16	210	22	250	139,7	8 x 18mm
DN150-VLF168-16	240	22	285	168,3	8 x 22mm
DN200-VLF219-16	295	24	340	219,1	12 x 22mm

Vlakke lasflenzen staal EN1092-1 (voorheen DIN 2576)

Vlakke lasflenzen in PN6 (DIN 2573) en in andere maten zijn op aanvraag leverbaar.



Staal EN1092-1 ST37,2 - 16 bar

FLEN	S	D		ID (mm)	i (mm)	
DN015-SLF021-16	65	14	16	95	21,3	4 x 14mm
DN020-SLF026-16	75	16	16	105	26,9	4 x 14mm
DN025-SLF033-16	85	16	16	115	33,7	4 x 14mm
DN032-SLF042-16	100	16	16	140	42,4	4 x 18mm
DN040-SLF048-16	110	16	16	150	48,3	4 x 18mm
DN050-SLF060-16	125	18	16	165	60,3	4 x 18mm
DN065-SLF076-16	145	18	16	185	76,1	8 x 18mm
DN080-SLF088-16	160	20	16	200	88,9	8 x 18mm
DN100-SLF114-16	180	20	16	220	114,3	8 x 18mm
DN125-SLF139-16	210	22	16	250	139,7	8 x 18mm
DN150-SLF168-16	240	22	16	285	168,3	8 x 22mm
DN200-SLF219-16	295	24	16	340	219,1	12 x 22mm

Staal EN1092-1 ST37,2 - 10 bar

FLEN	S	D		ID (mm)	i (mm)	
DN080-SLF088-10	160	20	10	200	88,9	4 x 18mm
DN200-SLF219-10	295	24	10	340	219,1	8 x 22mm
DN250-SLF273-10	350	26	10	395	273,0	12 x 22mm
DN300-SLF323-10	400	26	10	445	323,9	12 x 22mm
DN350-SLF355-10	460	28	10	505	355,6	16 x 22mm
DN400-SLF406-10	515	32	10	565	406,4	16 x 26mm
DN450-SLF457-10	565	26	10	615	457,0	20 x 27mm
DN500-SLF508-10	620	26	10	670	508,0	20 x 27mm



Flenzen - staal

Blindflenzen staal EN1092-5 (voorheen DIN 2527)



Staal EN1092-5 ST37 - 16 bar

FLEN	S	D	bar	ID mm	
DN015-BF-16	65	14	16	95	4 x 14mm
DN020-BF-16	75	16	16	105	4 x 14mm
DN025-BF-16	85	16	16	115	4 x 14mm
DN032-BF-16	100	16	16	140	4 x 18mm
DN040-BF-16	110	16	16	150	4 x 18mm
DN050-BF-16	125	18	16	165	4 x 18mm
DN065-BF-16	145	18	16	185	8 x 18mm
DN080-BF-16	160	20	16	200	8 x 18mm
DN100-BF-16	180	20	16	220	8 x 18mm
DN125-BF-16	210	22	16	250	8 x 18mm
DN150-BF-16	240	22	16	285	8 x 22mm



Staal EN1092-5 ST37 - 10 bar

FLEN	S	D	bar	ID mm	
DN080-BF-10	160	20	10	200	4 x 18mm
DN200-BF-10	295	24	10	340	8 x 22mm
DN250-BF-10	350	26	10	395	12 x 22mm
DN300-BF-10	400	26	10	445	12 x 22mm
DN350-BF-10	460	26	10	505	16 x 22mm
DN400-BF-10	515	26	10	565	16 x 26mm
DN450-BF-10	565	28	10	615	20 x 27mm
DN500-BF-10	620	28	10	670	20 x 26mm

Universele HD flenspakking ring



Zonder boutgaten - 16 bar

FLEN	To Suit
PF16DN015	DN015
PF16DN020	DN020
PF16DN025	DN025
PF16DN032	DN032
PF16DN040	DN040
PF16DN050	DN050
PF16DN065	DN065
PF16DN080	DN080
PF16DN100	DN100
PF16DN125	DN125
PF16DN150	DN150
PF10DN200	DN200
PF16DN250	DN250
PF16DN300	DN300
PF16DN350	DN350

Universele bouten voor flenzen

Staal 8.8 gegalvaniseerd

FLEN			L mm
FBOU12X50	M12	14	50
FBOU16X65	M16	18	65
FBOU20X90	M20	22	90
FBOU24X90	M24	26 & 27	90

Universele moeren voor flenzen

Staal 8.8 gegalvaniseerd

FLEN		
FMOERM12	M12	14
FMOERM16	M16	18
FMOERM20	M20	22
FMOERM24	M24	26 & 27

Universele sluitringen voor flenzen

Staal 8.8 gegalvaniseerd

FLEN		
FSLRINGM12	M12	14
FSLRINGM16	M16	18
FSLRINGM20	M20	22
FSLRINGM24	M24	26 & 27

Universele veerringen voor flenzen

Staal 8.8 gegalvaniseerd

FLEN		
FVEERRINGM12	M12	14
FVEERRINGM16	M16	18
FVEERRINGM20	M20	22
FVEERRINGM24	M24	26 & 27

Andere uitvoeringen en materialen zijn op aanvraag leverbaar.

